

EXISTING PLAN OF COLLEGE BUILDING OF CHANDU RAM SUTHAR MEMORIAL COLLEGE AT CHAK NO. 5 CHN KHATA NO. 19 KHASRA NO. 8 KILA NO. 9-12 AT CHHANI BARI TEHSIL BHADRA DISTRICT HANUMANGARH (RAJ.)

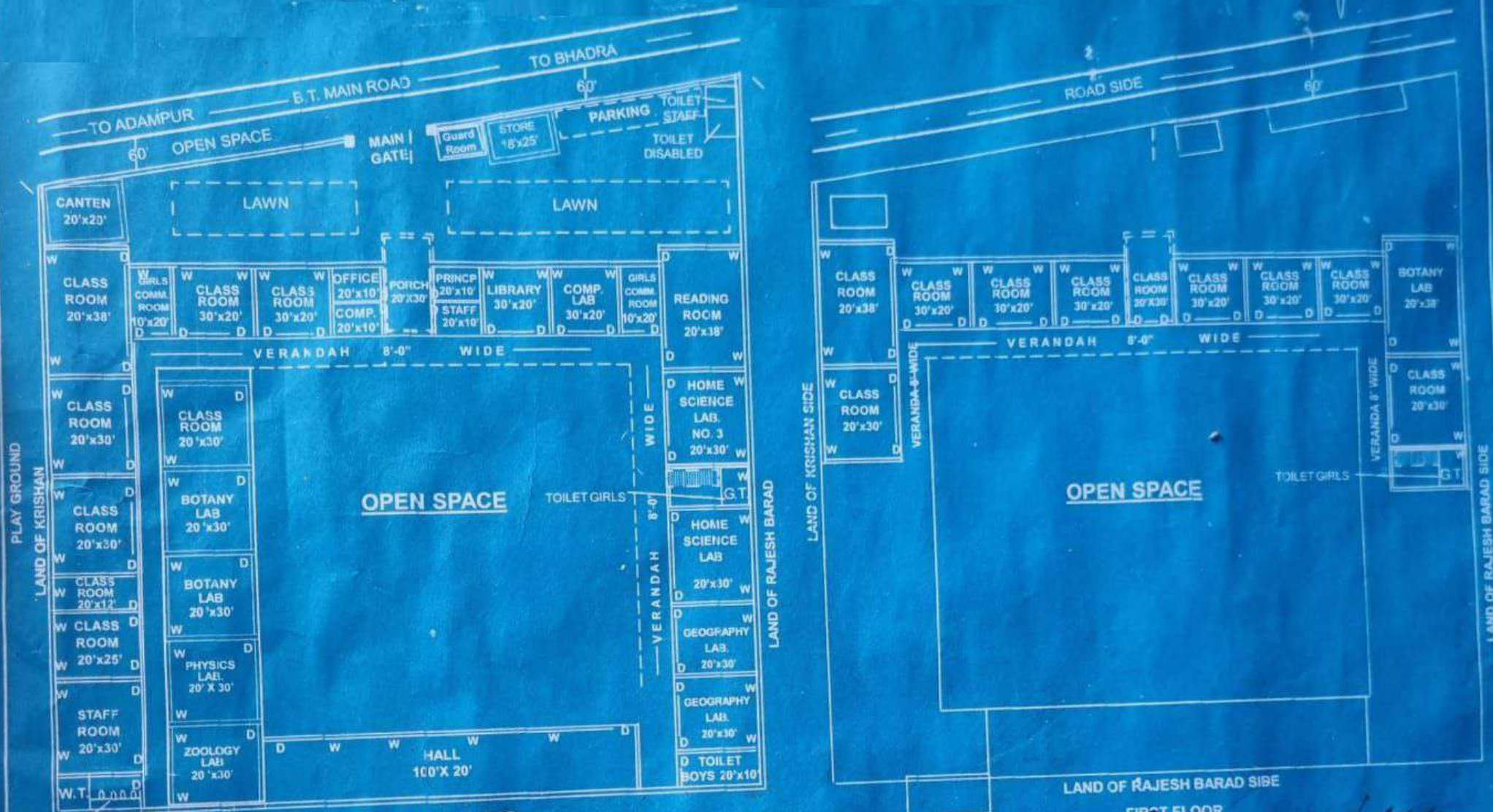

LAND OF RAJESH BARAD
GROUND FLOOR

FIRST FLOOR

TOTAL LAND AREA :-	54446 SQFT	OR	5060.00 SQMTR.
BUILT UP AREA GROUND FLOOR :-	27270 SQFT	OR	2534.38 SQMTR.
BUILT UP AREA FIRST FLOOR :-	8300 SQFT	OR	771.37 SQMTR.
GRAND TOTAL BUILT UP AREA :-	35570 SQFT	OR	3305.75 SQMTR.

S. Suthar
Secretary
Chandu Ram Suthar Memorial
Shikshan Sansthan
(Chhani Bari, Teh. Bhadra, Dist. Hanumangarh)

[Signature]
अभिजातजी अशोकजी
स. नं. 206/25
बहादुर - रावत (राज.)
12/05/25
12/05/25